

BID/PROPOSAL

COMMODITY: DISHWASHER AND MERCHANDISER REFRIGERATORS DATE: 1/5/2024

FORMAL BID NO. _____ PUBLIC BID NO. 101333

BIDS ARE TO BE RECEIVED IN URI PURCHASING DEPARTMENT BY: DATE: 1/30/2024 TIME: 12:00 PM
Eastern Time

BUYER: CAMELY MACHADO/dz SURETY REQUIRED: YES: _____ NO: X

PRE-BID/PROPOSAL CONFERENCE: DATE: _____ TIME: _____

MANDATORY: YES: _____ NO: _____

LOCATION: _____

Questions concerning this solicitation must be received by: DATE: 1/16/2024 TIME: 12:00 PM

Questions are to be submitted in a *Microsoft Word* document to: **URIPurchasing@uri.edu**

Please reference the Bid Number on all correspondence. Questions received, if any, will be posted on the internet as an addendum to the bid. It is the responsibility of all interested parties to download this information.

For Bid Solicitation Information visit: <http://web.uri.edu/purchasing/bid-information/>

STATEMENT REGARDING COVID-19

Effective immediately, we are suspending all in-person public bid openings until further notice.

Public Bid responses will be publicly read via Webex video conferencing. To participate in the bid opening, please visit the following site at the scheduled bid opening date and time:

* URL: <https://univofri.webex.com/meet/uripurchasing>

**No offer will be considered that is not accompanied by the attached
University of Rhode Island Bidder Certification Form/Contract Offer
completed and signed by the offeror.**

COMPANY NAME: _____

STREET AND NUMBER: _____

CITY, STATE & ZIP CODE: _____

Print Name and Title _____

Telephone Number/Facsimile Number _____

Signature _____

Date _____

E-mail address _____

THIS BID WILL NOT BE HONORED UNLESS SIGNED

The University of Rhode Island is an equal opportunity employer committed to the principles of affirmative action.

Rev. 5/7/21

University of Rhode Island Bidder Certification Form
Board of Trustees Procurement Regulations

ALL OFFERS ARE SUBJECT TO THE REQUIREMENTS, PROVISIONS AND PROCEDURES CONTAINED IN THIS CERTIFICATION FORM. Offerors are expected to read, sign and comply with all requirements. Failure to do so may be grounds for disqualification of the offer contained herein.

Rules for Submitting Offers

This Certification Form must be attached in its entirety to the front of the offer and shall be considered an integral part of each offer made by a vendor to enter into a contract with the University of Rhode Island. As such, submittal of the entire Bidder Certification Form, signed by a duly authorized representative of the offeror attesting that he/she (1) has read and agrees to comply with the requirements set forth herein and (2) to the accuracy of the information provided and the offer extended, is a mandatory part of any contract award.

To assure that offers are considered on time, each offer must be submitted with the specific Bid/RFP/LOI number, date and time of opening marked in the upper left hand corner of the envelope. Each bid/offer must be submitted in separate sealed envelopes.

A complete signed (in ink) offer package must be delivered to the University of Rhode Island Purchasing Office by the time and date specified for the opening of responses in a sealed envelope.

Bid responses must be submitted on the URI bid solicitation forms provided, indicating brand and part numbers of items offered, as appropriate. Bidders must submit detailed cuts and specs on items offered as equivalent to brands requested WITH THE OFFER. Bidders must be able to submit samples if requested.

Documents misdirected to other State or University locations or which are not present in the University of Rhode Island Purchasing Office at the time of opening for whatever cause will be deemed to be late and will not be considered. For the purposes of this requirement, the official time and date shall be that of the time clock in the reception area of the University of Rhode Island Purchasing Office. Postmarks shall not be considered proof of timely submission.

RIVIP SOLICITATIONS. To assure maximum access opportunities for users, public bid solicitations shall be posted on the RIVIP for a minimum of seven days and no amendments shall be made within the last five days before the date an offer is due. Except when access to the Web Site has been severely curtailed and it is determined by the Purchasing Agent that special circumstances preclude extending a solicitation due date, requests to mail or fax hard copies of solicitations will not be honored.

PRICING. Offers are irrevocable for sixty (60) days from the opening date (or such other extended period set forth in the solicitation), and may not be withdrawn, except with the express permission of the University Purchasing Agent. All pricing will be considered to be firm and fixed unless otherwise indicated. The University of Rhode Island is exempt from Federal excise taxes and State Sales and Use Taxes. Such taxes shall not be included in the bid price.

ALL PRICES QUOTED ARE FOB DESTINATION.

DELIVERY and PRODUCT QUALITY. All offers must define delivery dates for all items; if no delivery date is specified, it is assumed that immediate delivery from stock will be made. The contractor will be responsible for delivery of materials in first class condition. Rejected materials will be at the vendor's expense.

PREVAILING WAGE, OSHA SAFETY TRAINING and APPRENTICESHIP REQUIREMENTS. Bidders must comply with the provisions of the Rhode Island labor laws, including R.I. Gen. Laws §§ 37-13-1 et seq. and occupational safety laws, including R.I. Gen. Laws §§ 28-20-1 et seq. These laws mandate for public works construction projects the payment of prevailing wage rates, the implementation and maintenance of occupational safety standards, and for projects with a minimum value of \$1 Million, the employment of apprentices. The successful Bidder must submit certifications of compliance with these laws from each of its subcontractors prior to their commencement of any work. Prevailing wage rates, apprenticeship requirements, and other workforce and safety regulations are accessible at www.dlt.ri.gov.

PUBLIC RECORDS. Offerors are advised that all materials submitted to the University for consideration in response to this solicitation will be considered without exception to be Public Records pursuant to Title 38 Chapter 2 of the Rhode Island General Laws, and will be released for inspection immediately upon request once an award has been made. Offerors are encouraged to attend public bid/RFP openings to obtain information; however, bid/RFP response summaries may be reviewed after award(s) have been made by visiting the Rhode Island Vendor Information Program (RIVIP) at www.purchasing.ri.gov > Solicitation Opportunities > Other Solicitation Opportunities. Telephone requests for results will not be honored. Written requests for results will only be honored if the information is not available on the RIVIP.

Award will be made to the responsive and responsible offeror quoting the lowest net price in accordance with specifications, for any individual item(s), for major groupings of items, or for all items listed, at the University's sole option.

BID SURETY. Where bid surety is required, bidder must furnish a bid bond or certified check for 5% of the bid total with the bid, or for such other amount as may be specified. Bids submitted without a required bid surety will not be considered.

SPECIFICATIONS. Unless specified “no substitute”, product offerings equivalent in quality and performance will be considered (at the sole option of the University) on the condition that the offer is accompanied by detailed product specifications. Offers which fail to include alternate specifications may be deemed nonresponsive.

VENDOR AUTHORIZATION TO PROCEED. When a purchase order, change order, contract/agreement or contract/agreement amendment is issued by the University of Rhode Island, no claim for payment for services rendered or goods delivered contrary to or in excess of the contract terms and scope shall be considered valid unless the vendor has obtained a written change order or contract amendment issued by the University of Rhode Island Purchasing Office PRIOR to delivery.

Any offer, whether in response to a solicitation for proposals or bids, or made without a solicitation, which is accepted in the form of an order OR pricing agreement made in writing by the University of Rhode Island Purchasing Office, shall be considered a binding contract.

REGULATIONS, GENERAL TERMS AND CONDITIONS GOVERNING STATE AND THE UNIVERSITY OF RHODE ISLAND CONTRACTS. This solicitation and any contract or purchase order arising from it are issued in accordance with the specific requirements described herein, and the State’s [Purchasing Laws](#) and the [URI Board of Trustees Regulations and General Terms and Conditions of Purchase](#).

EQUAL EMPLOYMENT OPPORTUNITY. Compliance certificate and agreement procedures will apply to all awards for supplies or services valued at \$10,000 or more. Minority Business Enterprise policies and procedures, including subcontracting opportunities as described in Title 37 Chapter 14.1 of the Rhode Island General Laws also apply.

PERFORMANCE BONDS. Where indicated, successful bidder must furnish a 100% performance bond and labor and payment bond for contracts subject to Title 37 Chapters 12 and 13 of the Rhode Island General Laws. All bonds must be furnished by a surety company authorized to conduct business in the State of Rhode Island. Performance bonds must be submitted within 21 calendar days of the issuance of a tentative notice of award.

DEFAULT and NON-COMPLIANCE Default and/or non-compliance with the requirements and any other aspects of the award may result in withholding of payment(s), contract termination, debarment, suspension, or any other remedy necessary that is in the best interest of the state/University of Rhode Island.

COMPLIANCE Vendor must comply with all applicable federal, state and local laws, regulations and ordinances.

SPRINKLER IMPAIRMENT AND HOT WORK. The Contractor agrees to comply with the practices of the State’s Insurance carrier for sprinkler impairment and hot work. Prior to performing any work, the Contractor shall obtain the necessary information for compliance from the Risk Management Office at the Department of Administration or the Risk Management Office at the University of Rhode Island.

Each bid proposal for a *public works project* must include a “public copy” to be available for public inspection upon the opening of bids. **Bid Proposals that do not include a copy for public inspection will be deemed nonresponsive.**

For further information on how to comply with this statutory requirement, see [R.I. Gen. Laws §§ 37-2-18\(b\) and \(j\)](#). Also see State of Rhode Island Procurement Regulation 5.11 at : <https://ridop.ri.gov/about-us/procurement-statutes-and-regulations>

SECTION 2 – DISCLOSURES

ALL CONTRACT AWARDS ARE SUBJECT TO THE FOLLOWING DISCLOSURES & CERTIFICATIONS

Offerors must respond to every disclosure statement. A person authorized to enter into contracts must sign the offer and attest to the accuracy of all statements.

Indicate Yes (Y) or No (N):

____ 1 State whether your company, or any owner, stockholder, officer, director, member, partner, or principal thereof, or any subsidiary or affiliated company, has been subject to suspension or debarment by any federal, state, or municipal government agency, or the subject of criminal prosecution, or convicted of a criminal offense with the previous five (5) years. If Yes, then provide details below.

____ 2 State whether your company, or any owner, stockholder, officer, director, member, partner, or principal thereof, or any subsidiary or affiliated company, has had any contracts with a federal, state or municipal government agency terminated for any reason within the previous five (5) years. If Yes, then provide details below.

____ 3 State whether your company or any owner, stockholder, officer, director, member, partner, or principal thereof, or any subsidiary or affiliated company, has been fined more than \$5000 for violation(s) of Rhode Island environmental laws by the Rhode Island Department of Environmental Management within the previous five (5) years. If Yes, then provide details below.

____ 4 State whether any officer, director, manager, stockholder, member, partner, or other owner or principal of the Bidder is serving or has served within the past two calendar years as either an appointed or elected official of any state governmental authority or quasi-public corporation, including without limitation, any entity created as a legislative body or public or state agency by the general assembly or constitution of this state. If Yes, then provide details below.

IF YOU HAVE ANSWERED “YES” TO QUESTIONS #1 – 4 PROVIDE DETAILS/EXPLANATION IN AN ATTACHED STATEMENT. INCOMPLETE CERTIFICATION FORMS SHALL BE GROUNDS FOR DISQUALIFICATION OF OFFER.

SECTION 3 - OWNERSHIP DISCLOSURE

Vendors must provide all relevant information. Bid proposals submitted without a complete response may be deemed nonresponsive.

If the vendor is privately held, the vendor shall provide ownership information below.

List each officer, director, manager, stockholder, member, partner, or other owner or principle of the Bidder, and each intermediate parent company and the ultimate parent company of the Bidder. For each individual, provide his or her name, business address, principal occupation, position with the Vendor, and the percentage of ownership, if any, he or she holds in the Vendor, and each intermediate parent company and the ultimate parent company of the Vendor.

If the company is publicly held, the vendor may provide owner information about only those stockholders, members, partners, or other owners that hold at least 10% of the record or beneficial equity interests of the vendor; otherwise, complete ownership disclosure is required.

SECTION 4 - CERTIFICATIONS

Bidders must respond to every statement. Bid proposals submitted without a complete response may be deemed nonresponsive.

Indicate "Y" (Yes) or "N" (No), and if "No," provide details below.

THE VENDOR CERTIFIES THAT:

____ 1 I/we certify that I/we will immediately disclose, in writing, to the University Purchasing Agent any potential conflict of interest which may occur during the course of the engagement authorized pursuant to this contract.

____ 2 I/we acknowledge that, in accordance with (1) Chapter §37-2-54(c) of the Rhode Island General Laws "no purchase or contract shall be binding on the state or any agency thereof unless approved by the Department [of Administration] or made under general regulations which the Chief Purchasing Officer may prescribe," and (2) RIGL section §37-2-7(16) which identifies the URI Board of Trustees as a public agency and gives binding contractual authority to the University Purchasing Agent, including change orders and other types of contracts and under State Purchasing Regulation 8.2.B any alleged oral agreement or arrangements made by a bidder or contractor with any agency or an employee of the University of Rhode Island may be disregarded and shall not be binding on the University of Rhode Island.

____ 3 I/we certify that I or my/our firm possesses all licenses required by Federal and State laws and regulations as they pertain to the requirements of the solicitation and offer made herein and shall maintain such required license(s) during the entire course of the contract resulting from the offer contained herein and, should my/our license lapse or be suspended, I/we shall immediately inform the University of Rhode Island Purchasing Agent in writing of such circumstance.

____ 4 I/we certify that I/we will maintain required insurance during the entire course of the contract resulting from the offer contained herein and, should my/our insurance lapse or be suspended, I/we shall immediately inform the University of Rhode Island Purchasing Agent in writing of such circumstance.

____ 5 I/we certify that I/we understand that falsification of any information herein or failure to notify the University of Rhode Island Purchasing Agent as certified herein may be grounds for suspension, debarment and/or prosecution for fraud.

____ 6 I/we acknowledge that the provisions and procedures set forth in this form apply to any contract arising from this offer.

____ 7 I/we acknowledge that I/we understand the State's Purchasing Laws ([§37-2 of the General Laws of Rhode Island](#)) and the [URI Board of Trustees Regulations](#) apply as the governing conditions for any contract or purchase order I/we may receive from the University of Rhode Island, including the offer contained herein.

____ 8 I/we certify that the bidder: (i) is not identified on the General Treasurer's list, created pursuant to R.I. Gen. Laws § 37-2.5-3, as a person or entity engaging in investment activities in Iran described in § 37-2.5-2(b); and (ii) is not engaging in any such investment activities in Iran.

____ 9 If the product is subject to Department of Commerce Export Administration Regulations (EAR) or International Traffic in Arms Regulations (ITAR), please provide the Export Control Classification Number (ECCN) or the US Munitions List (USML)
Category: _____

____ 10 I/we certify that the above information is correct and complete.

IF YOU ARE UNABLE TO CERTIFY YES TO QUESTIONS #1 – 8 and 10 OF THE FOREGOING, PROVIDE DETAILS/EXPLANATION IN AN ATTACHED STATEMENT. INCOMPLETE CERTIFICATION FORMS SHALL BE GROUNDS FOR DISQUALIFICATION OF OFFER.

Signature below commits vendor to the attached offer and certifies (1) that the offer has taken into account all solicitation amendments where applicable, (2) that the above statements and information are accurate and that vendor understands and has complied with the requirements set forth herein.

Vendor/Company Name: _____

Vendor's Signature: _____ Bid Number: _____ Date: _____
(Person Authorized to enter into contracts; signature must be in ink) (if applicable)

Print Name and Title of Company official signing offer

ATTACHMENT "A"

ITEM NO.	DESCRIPTION	QUANTITY	UOM	UNIT PRICE	EXTENDED PRICE	UNIT PRICE	EXTENDED PRICE	ITEM NO.
----------	-------------	----------	-----	------------	----------------	------------	----------------	----------

INSTRUCTIONS:

IF BIDDING ON ANY ITEM, THE ENTIRE BID MUST BE RETURNED. THE PRICE COLUMN ON THE RIGHT WILL BE DETACHED TO CREATE A BID TABULATION SPREAD SHEET FOR THE "OFFICIAL BID ANALYSIS", THEREFORE:

- A. VENDOR NAME MUST APPEAR IN BOTH COLUMNS ON "EVERY" PAGE UNDER THE WORDS "BIDDER"
- B. PRICE COLUMNS MUST CONTAIN "EXACTLY" THE SAME INFORMATION.
- C. ANY SUPPLEMENTARY INFORMATION MUST BE REPEATED IN "BOTH" COLUMNS.
- D. TO ASSURE THAT OFFERS ARE CONSIDERED ON TIME, EACH OFFER MUST BE SUBMITTED WITH SPECIFIC BID/RFP NUMBER (PROVIDED ABOVE), DATE AND TIME OF OPENING MARKED IN THE UPPER LEFT HAND CORNER OF ENVELOPE. EACH BID/OFFER MUST BE SUBMITTED IN SEPARATE SEALED ENVELOPES:

MAIL TO:	COURIER:
UNIVERSITY OF RHODE ISLAND P.O. BOX 1773 PURCHASING DEPARTMENT KINGSTON, RI 02881	UNIVERSITY OF RHODE ISLAND PURCHASING DEPARTMENT DINING SERVICES DISTRIBUTION CENTER 10 TOOTELL ROAD KINGSTON, RI 02881-2010

DOCUMENTS MISDIRECTED TO OTHER STATE LOCATIONS OR WHICH ARE NOT PRESENT IN THE UNIVERSITY OF RHODE ISLAND PURCHASING DEPARTMENT AT THE TIME OF OPENING FOR WHATEVER CAUSE WILL BE DEEMED TO BE LATE AND WILL NOT BE CONSIDERED. FOR THE PURPOSE OF THIS REQUIREMENT, THE OFFICIAL TIME AND DATE SHALL BE THAT OF THE TIME CLOCK IN THE UNIVERSITY OF RHODE ISLAND PURCHASING DEPARTMENT. POSTMARKS SHALL NOT BE CONSIDERED PROOF OF TIMELY SUBMISSION.

FAILURE TO COMPLETE FORM AS INSTRUCTED MAY BE GROUNDS FOR "DISQUALIFICATION".

- GROUP PURCHASING ORGANIZATIONS (GPO):
THE UNIVERSITY OF RHODE ISLAND IS A MEMBER OF THE FOLLOWING:
- 1) Educational & Institutional Cooperative Purchasing (E&I)
 - 2) Provista

DO NOT ATTACH QUOTES. QUOTATIONS SUBMITTED WITH BID RESPONSES WILL NOT BE CONSIDERED. ALL BID RESPONSES ARE IN ACCORDANCE WITH THE ATTACHED BID SPECIFICATIONS AND THE BOARD OF TRUSTEES PROCUREMENT REGULATIONS

ATTACHMENT "A"

ITEM NO.	DESCRIPTION	QUANTITY	UOM	UNIT PRICE	EXTENDED PRICE	UNIT PRICE	EXTENDED PRICE	ITEM NO.
NO SUBSTITUTES ON BRAND OR MODEL								
1	DISHWASHER Hobart LXeH SERIES Volatge: 120/208-240 (3W)/60/1 1 ea 17" Stainless steel base 1 each Power cord kit SPECS ATTACHED	1	EA	\$ _____	\$ _____	\$ _____	\$ _____	1
2	AVANTCO GDC-49-HC53" BLACK SWING DOOR MERCHANDISER REFRIGERATOR with LED LIGHTING on casters SPECS ATTACHED Delivery to: Dining Services Food Distribution Center 10 Tootell Rd Kingston, RI 02881 SPECIFICATIONS ALL DIFFERENCES BETWEEN THE UNIVERSITY'S REQUIREMENT AND EACH VENDOR'S BID MUST BE CLEARLY NOTED, ITEM BY ITEM. BIDDERS MUST INCLUDE LITERATURE FOR THE ITEMS THEY ARE BIDDING. ITEMS IN CATALOGS MUST BE CLEARLY MARKED AND PAGES TABBED.	3	EA	\$ _____	\$ _____	\$ _____	\$ _____	2



Item #: 178GDC49HCB Project: # 2
Qty: 3 Date: Approval:

Avantco GDC-49-HC 53" Black Swing Glass Door Merchandiser Refrigerator with LED Lighting

Item #178GDC49HCB

Avantco Refrigeration

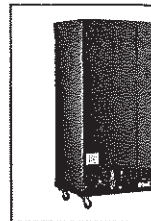
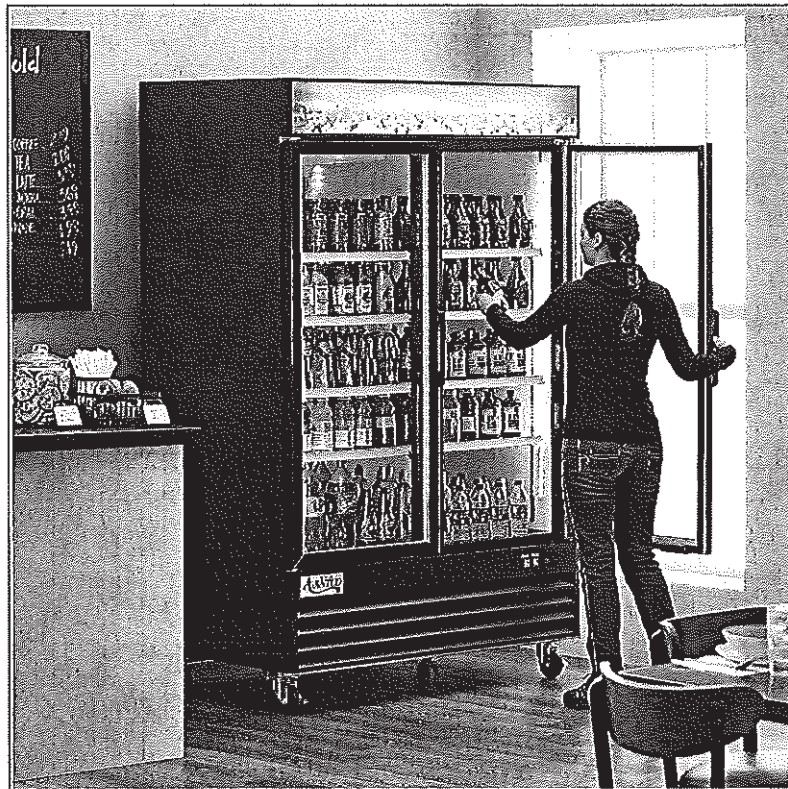

Technical Data

Width	53 1/8 Inches
Depth	31 7/8 Inches
Height	83 7/8 Inches
Power Cord Length	96 Inches
Interior Width	50 Inches
Left Door Opening Width	22 7/8 Inches
Right Door Opening Width	22 7/8 Inches
Interior Depth	28 3/8 Inches
Interior Height	61 7/8 Inches
Amps	3.14 Amps

Features

- Features (2) self-closing, anti-fog, dual-pane tempered glass swing doors with magnetic gaskets
- Interior LED lighting illuminates product; back-lit exterior top panel attracts customers' attention
- 8 adjustable shelves with price tag strip on each shelf
- Easy-to-use digital temperature controls
- 115V, 1/2 hp compressor; R290 refrigerant; 3.14 amps

Certifications



ETL, US



5-15P



Customizable

Technical Data

Phase	1 Phase
Voltage	115 Volts
Access Type	Doors
BTU (LBP)	1285 BTU
Capacity	42.5 cu. ft.
Color	Black
Compressor Location	Bottom Mounted
Door Style	Swing
Door Type	Glass
Features	Customizable LED Lighting
Hinge Location	Left/Right
Horsepower	1/2 HP
Individual Shelf Capacity	90 lb.
Installation Type	Freestanding
Interior Color	White
Number of Doors	2 Doors
Number of Shelves	8 Shelves
Plug Type	NEMA 5-15P
Refrigerant Capacity	3.5 oz.
Refrigerant Type	R-290
Sections	2 Sections
Temperature Range	33 - 40 Degrees F
Type	Merchandising Refrigeration

Plan View

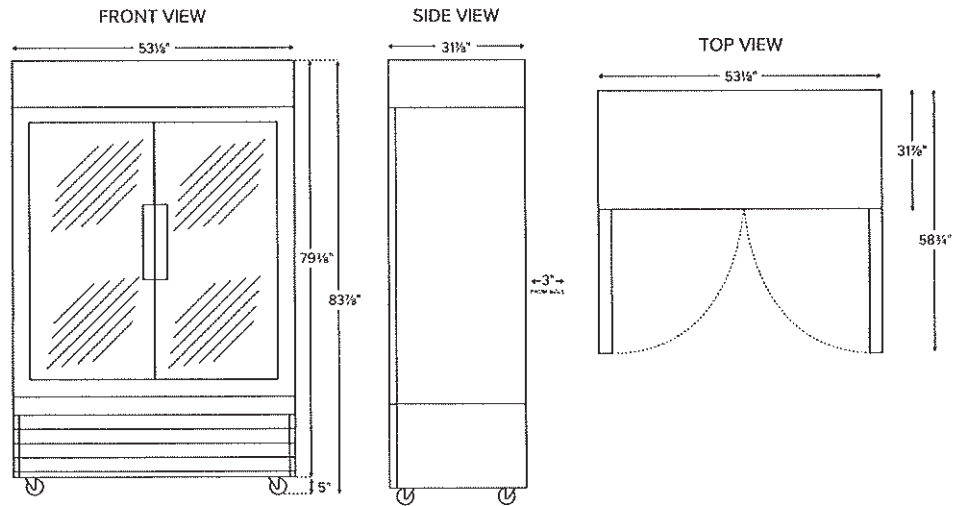



Notes & Details

Increase your sales of "grab and go" items like bottled tea and soda, or pre-packaged sandwiches and salads with Avantco GDC-49-HC 53" black merchandising refrigerator! Designed with sharp looks and usability in mind, this is the perfect display for your products with its sleek black finish and a lighted top graphics area. And, since the housing is made from black-coated steel, you can be sure that it will provide superior durability. Additionally, it has 2 anti-fogging, dual-pane tempered glass swing doors to ensure that customers always have a clear view of your products, while 8 epoxy-coated steel shelves help you stay organized. Each shelf can hold up to 90 lb. of product; the shelves easily adjust to accommodate changing inventory and menus. Interior LED lighting on the right side works to illuminate and further merchandise your products.

Designed to maintain temperatures from 33-40 degrees Fahrenheit, this refrigerator boasts a bottom-mounted hp compressor that runs on R290 refrigerant. This specialized refrigerant has an ozone depletion potential (ODP) and a global warming potential (GWP) of 3. In addition, the bottom-mounted design makes it easy for employees to load and unload products due to the raised bottom shelf. For optimal temperature retention, the entire cabinet is foamed in place using polyurethane insulation. Other helpful features include self-closing aided by magnetic gas automatic defrosting, and a digital temperature control. This item requires a 115V electrical connection for operation.

 **WARNING:** This product can expose you to chemicals including lead, which are known to the State of California to cause cancer, birth defects, and other reproductive harm. For more information, go to www.p65warnings.ca.gov.

Avantco Refrigeration



701 S Ridge Avenue, Troy, OH 45374
 1-888-4HOBART • www.hobartcorp.com

LXe HOT AND COLD

STANDARD FEATURES

- 32 racks per hour – LXeH
- 34 racks per hour – LXeC
- .74 gallons of water per rack
- Hot water or chemical sanitation units available
- Low chemical alert indicators
- Sense-A-Temp™ booster heater capable of 70° rise, provided on LXeH models
- Delime notification with cycle
- Chemical pump “auto-prime”
- Service diagnostics
- Deep drawn stainless steel tank
- Microcomputer, top mounted controls with digital cycle/temperature display
- Revolving upper and lower anti-clogging wash arms
- Revolving upper and lower rinse arms
- Removable stainless steel scrap screen
- Corrosion resistant pump
- Automatic pumped drain
- 17" door opening
- Automatic fill
- Detergent and rinse aid pumps standard (plus sanitizer pump on chemical machine)
- Electric tank heat
- Two dishracks – one peg and one combination type

STANDARD VOLTAGES

- ☒ 120/208-240(3W)/60/1 (LXeH model only)
- ☐ 120/60/1 (LXeC model only)

OPTIONS AT EXTRA COST

- ☐ 208-240(2W)/60/1 (LXeH model only)
- ☐ 208-240/60/3 (LXeH model only)

MODELS

- ☐ LXeC
- ☒ LXeH

ACCESSORIES

- ☒ Power cord kits
- ☐ Stainless steel base with 6" legs
- ☒ 17" stainless steel stand with storage
- ☐ External caster kit
- ☐ DWT-LXe drain water tempering kit

Specifications, Details and Dimensions on Back.

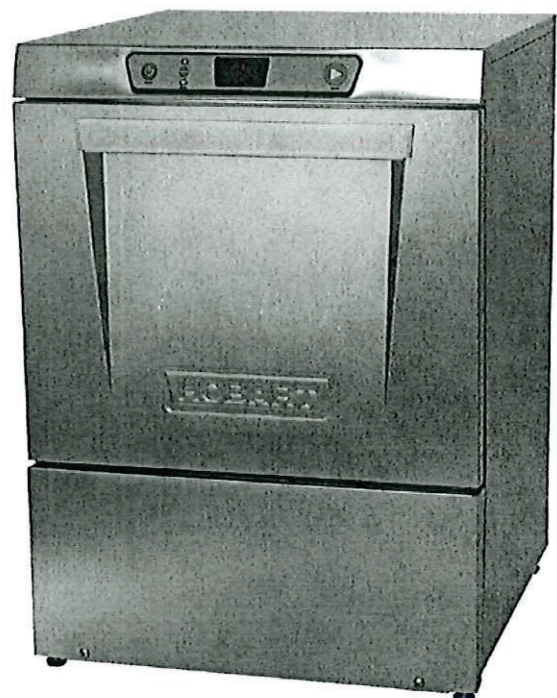

LXeH HOT

HOBART

701 S Ridge Avenue, Troy, OH 45374
1-888-4HOBART • www.hobartcorp.com

NOTICE

Required flowing water pressure to the dishmachine is 15-65 PSIG. If pressures higher than 65 PSIG are present, a pressure regulating valve must be installed in the water line to the dishmachine (by others).

Pressure gauge not required on pumped rinse machines.

Important: The chemical containers should be placed no higher than 10" above floor.

If chemical containers are to be placed in cabinet adjacent to machine, a 1/2" dia. hole is required in the cabinet to run chemical supply line.

Notes:

- All vertical machine dimensions taken from floor may be increased by 1".
- Moist air escapes from the door. Use only moisture resistant materials adjacent to dishmachine sides and top.
- A vent hood is not recommended above the undercounter dishmachine since it does not produce excessive vapors.

Plumbing notes:

- Water hammer arrestor (meeting ASSE-1010 Standard or equivalent) to be supplied (by others) in common water supply line at service connection.
- Recommended water hardness to be 3 grains or less for best results.
- If drain hose is looped above a sink, the loop must not exceed 38" AFF.

CONNECTION INFORMATION (AFF = ABOVE FINISHED FLOOR)

LEGEND

- E1 ELECTRICAL CONNECTION: 1-3/8" DIA. HOLE FOR 1" TRADE SIZE CONDUIT; 4-5/8" AFF.
- P1 SINGLE FILL AND RINSE CONNECTION: 3/4" FEMALE GARDEN HOSE FITTING ON 6' LONG HOSE SUPPLIED WITH MACHINE.; 110°F WATER MIN FOR LXeH
- P2 DRAIN CONNECTION: 5/8" BARB FITTING WITH 6' LONG HOSE SUPPLIED WITH MACHINE.

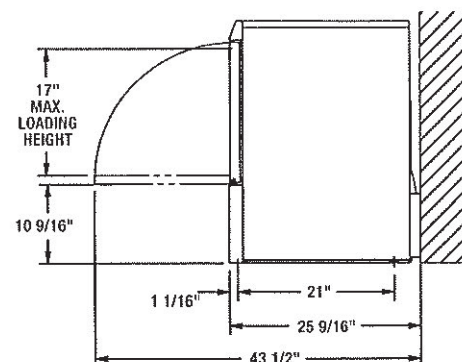
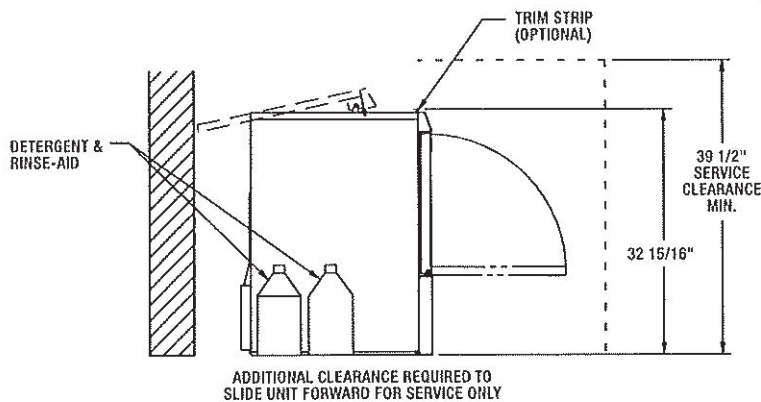
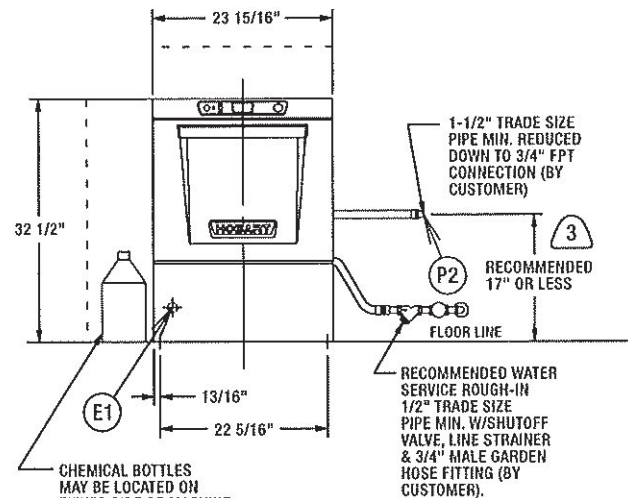
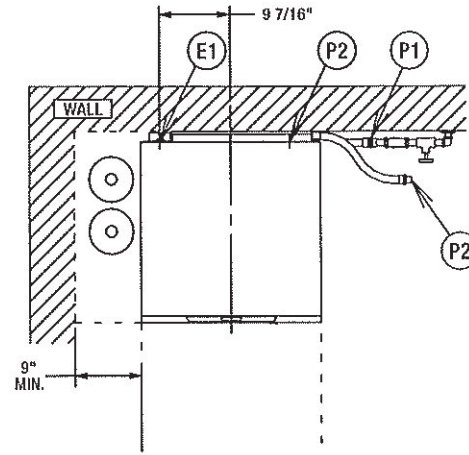

HEAT OUTPUT, BTU/HR		
MODEL	LATENT	SENSIBLE
LXeH	4600	4000

SHIPPING WEIGHTS		LXeH
NET WEIGHT OF MACHINE		150 LBS
DOMESTIC SHIPPING WEIGHT		170 LBS

MODEL	VOLTS/HERTZ/PHASE	RATED AMPS	MIN SUPPLY CKT CONDUCTOR AMPACITY	MAX PROTECTIVE DEVICE
LXeH	208-240/60/1	30.5	40	40
	120/208-240(3W)/60/1*	30.5	40	40
	208-240/60/3	23.9	30	30
	220-240/50/1	30.5	40	40

NOTE: FOR SUPPLY CONNECTIONS, USE COPPER WIRE ONLY RATED AT 90°C MINIMUM.
* THIS SYSTEM REQUIRES THREE POWER WIRES WHICH INCLUDES A CURRENT CARRYING NEUTRAL, AN ADDITIONAL FOURTH WIRE MUST BE PROVIDED FOR MACHINE GROUND.
ACCESSORY CORD KIT AVAILABLE FOR ALL MACHINES

WARNING

Electrical and grounding connections must comply with the applicable portions of the National Electrical Code and/or other local electrical codes.

Plumbing connections must comply with applicable sanitary, safety and plumbing codes. Drain and fill line configurations vary, some methods are shown on this drawing.

MODELS:
LXeH
00-947871
REV C

HOBART

701 S Ridge Avenue, Troy, OH 45374
1-888-4HOBART • www.hobartcorp.com

LX_eC COLD

⚠ WARNING

Do not premix other chemicals and sodium hypochlorite (liquid bleach). Mixing may cause hazardous gas to form.

NOTICE

Required flowing water pressure to the dishmachine is 15-65 PSIG. If pressures higher than 65 PSIG are present, a pressure regulating valve must be installed in the water line to the dishmachine (by others).

Pressure gauge not required on pumped rinse machines.

Important: Chemical containers should be placed no higher than 10" above floor.

If chemical containers are to be placed in cabinet adjacent to machine, a 1/2" dia. hole is required in the cabinet to run chemical supply line. Use only 6% or 8.4% sodium hypochlorite (liquid bleach) as sanitizing chemical to insure proper operation of dishmachine.

Certain materials including silver plate, aluminum and pewter are attacked by sodium hypochlorite (liquid bleach). See instructional manual.

Notes:

1. All vertical machine dimensions taken from floor may be increased by 1".
2. Moist air escapes from the door. Use only moisture resistant materials adjacent to dishmachine sides and top.
3. A vent hood is not recommended above the undercounter dishmachine since it does not produce excessive vapors.

Plumbing notes:

1. Water hammer arrestor (meeting ASSE-1010 Standard or equivalent) to be supplied (by others) in common water supply line at service connection.
2. Recommended water hardness to be 3 grains or less for best results.
3. If drain hose is looped above a sink, the loop must not exceed 38" AFF.

CONNECTION INFORMATION (AFF = ABOVE FINISHED FLOOR)

LEGEND

- E1 ELECTRICAL CONNECTION: 1-3/8" DIA. HOLE FOR 1" TRADE SIZE CONDUIT; 4-5/8" AFF.
- P1 SINGLE FILL AND RINSE CONNECTION: 3/4" FEMALE GARDEN HOSE FITTING ON 6' LONG HOSE SUPPLIED WITH MACHINE.; 120°F WATER MIN. FOR LX_eC, 140°F RECOMMENDED.
- P2 DRAIN CONNECTION: 5/8" BARB FITTING WITH 6' LONG HOSE SUPPLIED WITH MACHINE.

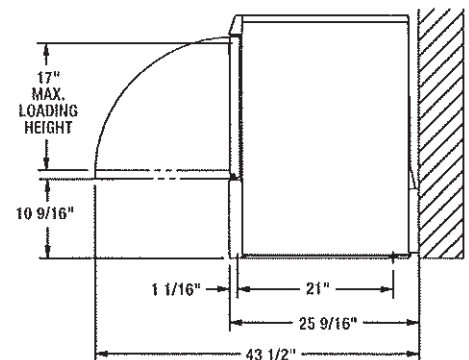
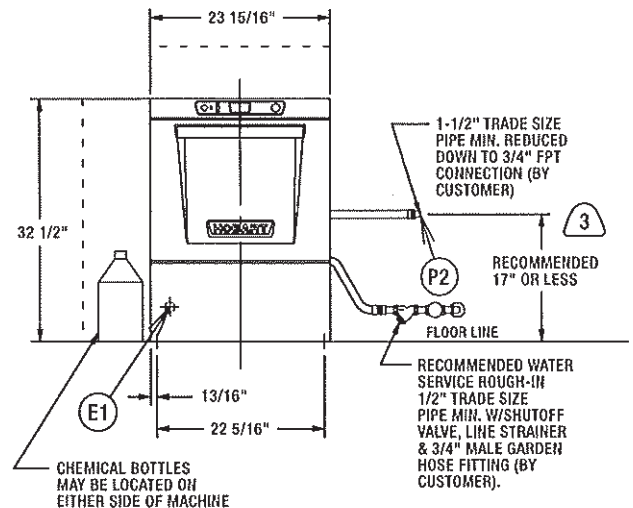
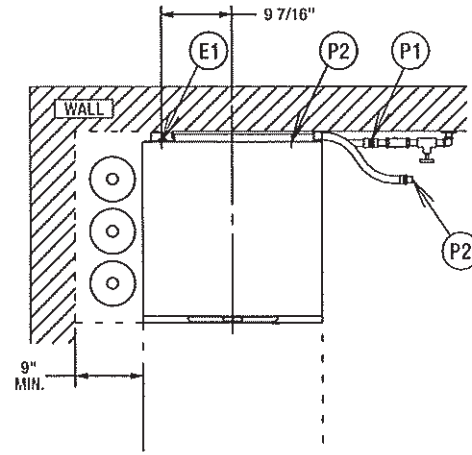
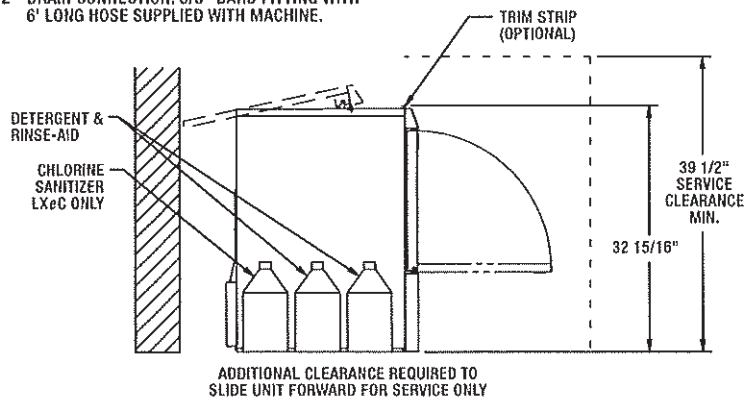

HEAT OUTPUT, BTU/HR			SHIPPING WEIGHTS		LX _e C
MODEL	LATENT	SENSIBLE	NET WEIGHT OF MACHINE		150 LBS
LX _e C	1900	800	DOMESTIC SHIPPING WEIGHT		170 LBS

MODEL	VOLTS/HERTZ/PHASE	RATED AMPS	MIN SUPPLY CKT CONDUCTOR AMPACITY	MAX PROTECTIVE DEVICE
LX _e C	120/60/1	13.4	20	20

NOTE: FOR SUPPLY CONNECTIONS, USE COPPER WIRE ONLY RATED AT 90°C MINIMUM.
ACCESSORY CORD KIT AVAILABLE FOR ALL MACHINES

⚠ WARNING

Electrical and grounding connections must comply with the applicable portions of the National Electrical Code and/or other local electrical codes.

Plumbing connections must comply with applicable sanitary, safety and plumbing codes. Drain and fill line configurations vary, some methods are shown on this drawing.

MODELS:
LX_eC
00-947871
REV C

LXe HOT AND COLD

HOBART

701 S Ridge Avenue, Troy, OH 45374
1-888-4HOBART • www.hobartcorp.com

SPECIFICATIONS

DESIGN: Front opening, equipped for installation in either freestanding or undercounter-type operations.

CONSTRUCTION: 300 series stainless steel tank, door and top panel.

PUMP: Centrifugal-type, integral with motor, horizontally mounted. Pump capacity 38 gpm.

MOTOR: Single phase, furnished for all electrical specifications. Factory sealed lubrication. Inherent overload protection with auto reset.

WASH AND RINSE CYCLE: Complete automatic type, controlled by solid-state electronics. Cycle may be interrupted any time by opening door. Cycle continues when door is closed.

- Initial cycle fills wash tank, to be recirculated each wash cycle. Some wash water is drained off before rinse cycle. Rinse cycle refreshes wash water and tank heat.

RINSE PUMP: Powered by a single phase motor, the rinse pump is made of high strength engineered composite material.

RINSE AND SANITATION:

- **LXeH:** Sanitation is accomplished by means of a built-in booster heater designed to raise temperature of water to a minimum of 180°F from an incoming water temperature of 110°F.
- **LXeC:** Sanitation is accomplished by injection of proper amount of sodium hypochlorite solution (liquid bleach) into final rinse water to achieve a minimum of 50PPM sanitizing solution. Injection of sodium hypochlorite is accomplished by a built-in sanitizing chemical pump.

PUMPED DRAIN: Machine automatically drains water through a built-in pump. Maximum 38" drain height permitted.

RACKING: Machines accommodate racks from 10" x 20" to 20" x 20". Also accepts 16" x 18" cafeteria trays.

NOTE: Certain materials, including silver, aluminum and pewter are attacked by Sodium Hypochlorite solution in the chemical sanitizing mode of operation.

SPECIFICATIONS: Listed by Underwriters Laboratories Inc. and NSF International.

MACHINE RATINGS	LXeC	LXeH
Racks per Hour Rate	34	32
Dishes per Hour (25 per Rack Avg.)	850	800
Glasses per Hour (36 per Rack Avg.)	1224	1152
Controls	Microcomputer	
Tank Capacity - Gallons	2.9	
Overall Dimensions - H x W x D	32½" x 23½" x 25½"	
Cycle Time - Seconds	105	109
Tank Heat	1.8 KW	
Electric Booster Heater	N/A	4.9 KW
Water Usage Per Rack - Gallons	.74	
Drain Design	Pumped	
Door Opening Height	17"	
Detergent Pump	Standard	
Rinse-Aid Pump	Standard	
Sanitizer Pump	Standard	N/A
Chemical Prime (auto prime)	Standard	
Peak Drain Flow - GPM	4.0	
Service Diagnostics	Standard	
70° Rise Sense-A-Temp™ Booster Heater	N/A	Standard
Incoming Water Temperature Required (minimum)	120°	110°